

BARBERS POINT HARBOR

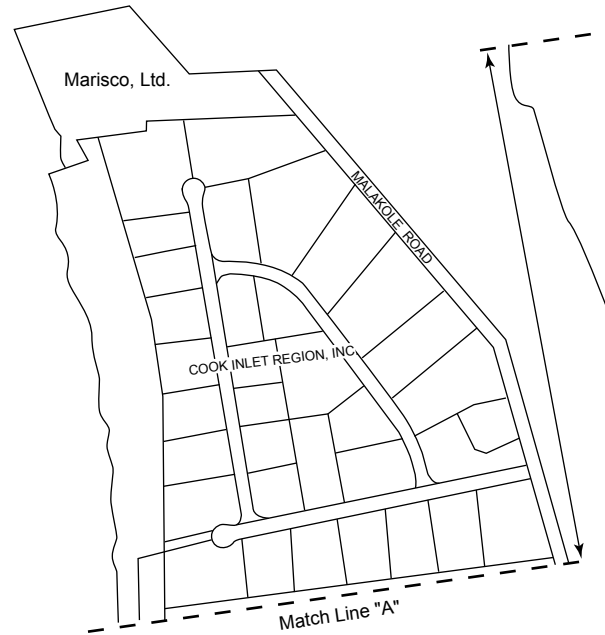

Match Line "A"

FARRINGTON HWY.

TO HONOLULU VIA H-1 FREEWAY

TO WAIANA

MALAKOLE ROAD

Chevron USA, Inc.

Project Site

Scale: 1" = 800'

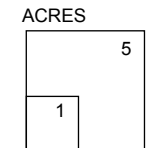
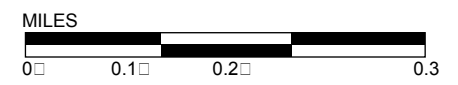

LEGEND

- KPD Land for Sale & Lease
- Occupied Lots
- CHILLC Land for Lease
- Plant Sanctuary
- Temporary Road
- Drainage Channel
- (M-T) Multi-Tenant

LETTERED LOTS

- A -  R&H Machinery
- B -  Vacant (0.998 Acs.)
- C -  South Pacific Furniture
- D -  Pacific Plasti-Vac
- E -  Millennium LLP
- F -  Philip Services Hawaii
- G -  Refrigerant Recycling
- H -  AT&T Wireless Services
- I -  John Groark & Assoc.
- J -  Hawaii Railings
- K -  Specialty Surfacing Co., Inc.
- L -  Diversified Energy Services
- M -  Valve Service & Supply
- N -  Abhe & Svoboda
- O -  Vacant (1.649 Acs.)
- P -  Family Towing
- Q -  Worldwide Moving & Storage
- R -  J & M Blasting
- S -  Albert C. Kobayashi Inc.
- T -  Aloha Int'l Moving Services
- U -  Aloha Truck Parts
- CHILLC -  Campbell Hawaii Investor LLC
- KPD -  Kapolei Property Development LLC

# James Campbell Industrial Park

Notice: This map is not intended to and shall not be interpreted as creating any obligation to sell, lease, develop or offer any of the Campbell Industrial Park lots noted herein. No rights or benefits of any type, whether incidental or direct, are conferred by this map on any persons or entities, whether present or future tenants or otherwise, and such parties shall not rely on any of the matters depicted herein. Lot size, buildable area, availability, and configuration, as well as the improvements and amenities shown herein, are subject to change at any time without notice. Updated January 2003